

# STEERING LINKAGE

1988 Jeep Cherokee

1988 STEERING  
Jeep Steering Linkage

All Models

## STEERING SERVICE PRECAUTIONS

All steering component fasteners are made of special quality materials. Replacement fasteners must be of same part number or equivalent. Tighten all fasteners to specification. Always use new cotter pins. DO NOT back off castle nuts to align cotter pin hole. Tighten nut to next slot that lines up with hole.

DO NOT hammer on ball studs. If threads are not clean and smooth, ball studs may turn in joint when nuts are tightened. Sleeve clamps must always be positioned as specified before tightening bolts.

## TROUBLE SHOOTING

Refer to TROUBLE SHOOTING - BASIC PROCEDURES article in the GENERAL TROUBLE SHOOTING section.

## REMOVAL & INSTALLATION

### TIE ROD REPLACEMENT

Removal & Installation

1) Remove cotter pins and retaining nuts at both ends of tie rod and connecting rod ball joints. Disconnect steering damper from tie rod. Using puller and appropriate adapters from Ball Joint Tool Kit (J-34503), remove tie rod ends from steering arms and connecting rod.

2) Loosen clamp bolts. Remove tie rod ends from adjusting sleeve noting the number of turns. To install, thread new tie rod ends into adjusting sleeve. Attach tie rod ends to steering arms and connecting rod. Tighten nuts.

3) Install new cotter pins. Attach steering damper. Check and adjust toe-in. See WHEEL ALIGNMENT SPECIFICATIONS & PROCEDURES article in WHEEL ALIGNMENT section. Tighten clamp bolts.

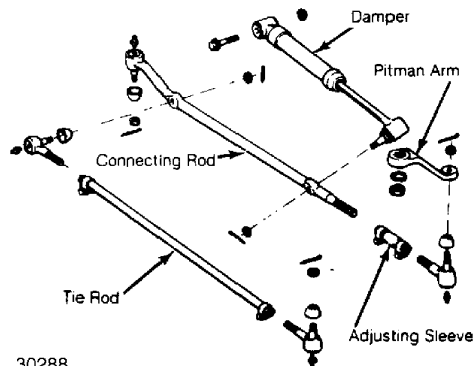

30288  
Fig. 1: Cherokee, Comanche, Wagoneer & Wrangler Steering Linkage

## STEERING DAMPER REPLACEMENT

Removal & Installation

1) Place front wheels in straight-ahead position. Remove lock nuts and washers from damper ends. Remove damper assembly and rubber bushings.

2) To install, place rubber bushings in damper eyelets. On Grand Wagoneer models, secure eyelet at push rod end to stud on tie rod bracket. Install rubber bushings in damper body eyelet. On Cherokee, Comanche, Wagoneer and Wrangler, install stud at push rod end into hole on tie rod.

3) On all models, attach opposite end of damper with bolt and lock nut (Cherokee, Comanche, Wagoneer and Wrangler) or with a lock nut (Grand Wagoneer). Tighten lock nuts.

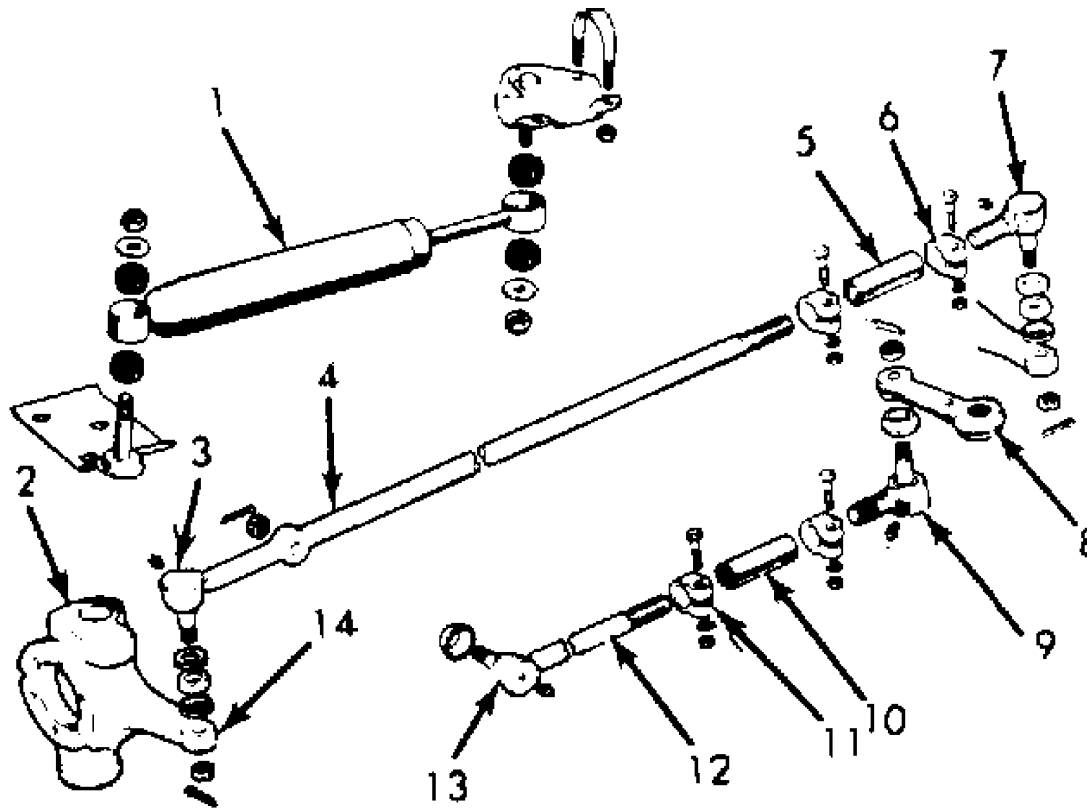

- 1. Steering Damper
- 2. Steering Knuckle
- 3. Tie Rod End
- 4. Tie Rod
- 5. Adjusting Sleeve
- 6. Clamps (2)
- 7. Tie Rod End

- 8. Pitman Arm
- 9. Connecting Rod End
- 10. Adjusting Sleeve
- 11. Clamps (2)
- 12. Connecting Rod
- 13. Connecting Rod End
- 14. Steering Knuckle Arm

30289

Fig. 2: Grand Wagoneer Steering Linkage

**WHEEL ALIGNMENT**

After performing appropriate service procedures, refer to WHEEL ALIGNMENT SPECIFICATIONS & PROCEDURES article in the WHEEL ALIGNMENT section.

## CONNECTING ROD REPLACEMENT

### Removal & Installation

Remove cotter pins and nuts from both ends of connecting rod. Using a separator, remove connecting rod. To install, place wheels in straight-ahead position. Center pitman arm. Install connecting rod. Tighten lock nuts. Install new cotter pins.

## TORQUE SPECIFICATIONS

### TORQUE SPECIFICATIONS TABLE

Application	Ft.Lbs. (N.m)
Clamp Bolt	
Grand Wagoneer .....	30 (41)
All Others .....	14 (19)
Connecting Rod Nut	
5/8" .....	70 (95)
9/16" .....	60 (82)
Pitman Arm-to-Shaft Nut .....	185 (251)
Steering Damper Lock Nut	
Wrangler .....	53 (71)
All Others .....	30 (41)
Tie Rod End Stud Nuts	
Grand Wagoneer .....	60 (82)
All Others .....	35 (47)